

INJECT THROUGH INJECTION TUBE SYSTEM
QUANTITY ESTIMATED BY VOID SPACE

OVERSIZED BACKER ROD 2.5" OPTIONAL

WILLSEAL CORESEAL WITH
I.T.S. INJECTION TUBE
ENGINEERED PROFILE

RETICULATED FOAM 2.5" X 3" OPTIONAL

FIELD APPLIED EPOXY
(BOTH SIDES OF JOINT)
EPOXY SUPPLIED

SPETEC I.T.S. INJECTION TUBE
FIELD APPLIED TO WILLSEAL CORESEAL

EXISTING CONCRETE SUBSTRATE

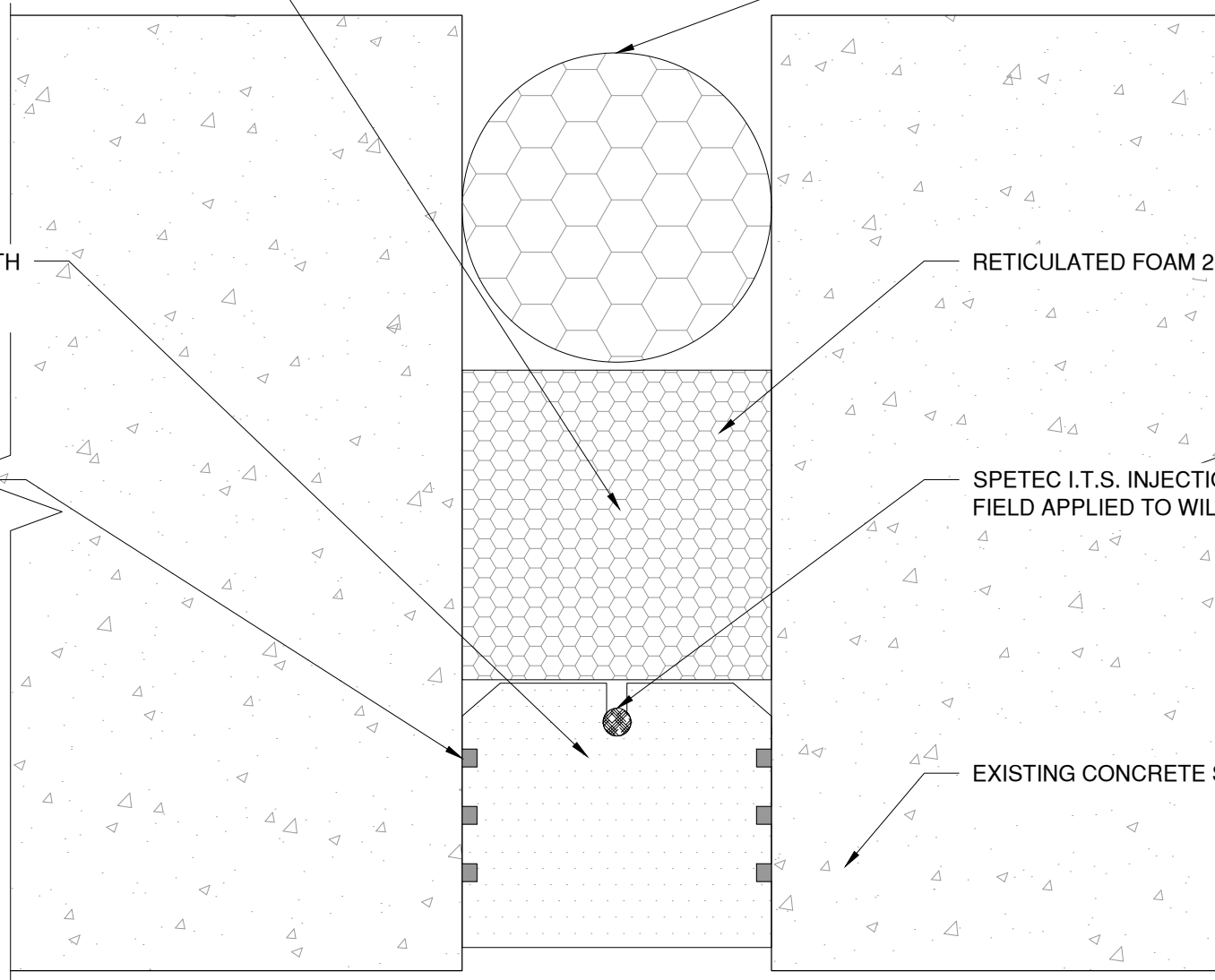

The architecture, engineering, and design of the project using the Willseal products are the responsibility of the project's design professional. All products and systems must comply with local building codes and standards. This detail is for general information and guidance only and Willseal specifically disclaims any liability for the use of this detail. The project design professional determines, in its sole discretion, whether this detail or a functionally equivalent detail is best suited for the project. This detail is subject to change without notice. Contact Willseal to ensure you have the most recent version.

Willseal Coreseal



Detail: Willseal Coreseal at Wall to Wall Application with Injection Tube (Plan View)

File Name:

Drawn by: HDE

Checked by: AM

Scale: NTS

Date: 7/5/2022

WC-WW-02



Willseal Technical Support: 800-274-2813

www.tremcocpg.com

Construction Products Group