

NOTE: BUILDING FACADE NOT SHOWN FOR CLARITY,  
EXOAIR PRODUCTS ARE NOT TO BE LEFT EXPOSED.

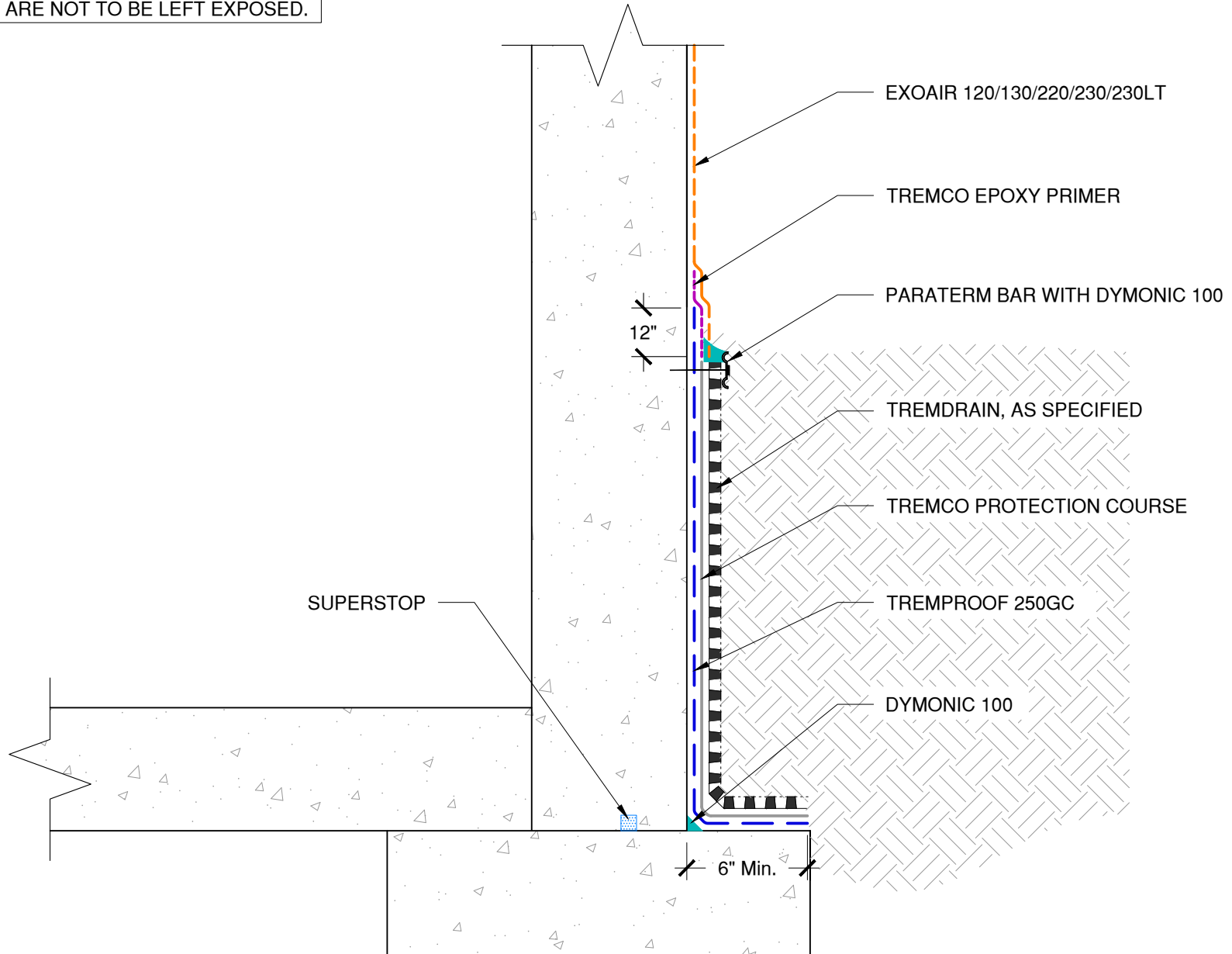

The architecture, engineering, and design of the project using the Tremco products are the responsibility of the project's design professional. All products and systems must comply with local building codes and standards. This detail is for general information and guidance only and Tremco specifically disclaims any liability for the use of this detail. The project design professional determines, in its sole discretion, whether this detail or a functionally equivalent detail is best suited for the project. This detail is subject to change without notice. Contact Tremco to ensure you have the most recent version.

**TREMproof 250GC**



Detail: ExoAir 120/130/220/230/230LT to TREMproof 250GC

Drawn by: KAB	Checked by: WH	Scale: NTS	Date: 2/26/2022
---------------	----------------	------------	-----------------

[www.tremcocpg.com](http://www.tremcocpg.com)

File Name:  
**C-250GC-T-06**

